



**34 Mazeppa Street South Ripley QLD**

4  2  2 

Apply through [realestate.com.au](https://www.realestate.com.au) Apply icon rhs of advertising and follow the prompts. We will only take into consideration this application process.

Once applications processed and deemed suitable for the property, we will be in contact to arrange for a private inspection

This property has been built with so much love and exquisite finishes that you will be the envy of all friends and family !

As you gently push the grand front wooden door you will be taken on a wonderful journey as your new home will provide you with the comfort you have been waiting for. The layout is perfect for the family so everyone has got

[For full version visit the website](https://www.lavieps.com.au)

**Type** : House  
**Price** : \$615/wk Absolutely Gorgeous Home!  
**View** : <https://www.lavieps.com.au/lease/qld/ipswich-west-moreton/south-ripley/residential/house/8149487>



**Nathalie Le Brun**  
07 3470 1777

**MASTER TEMPLATE DRAWING ISSUE STAMP**

DATE OF ORIGINAL ISSUE: 12.09.16  
 DRAFTING DEP. APPROVAL:  
 DATE OF CURRENT ISSUE: 12.09.16  
 ESTIMATING DEP. APPROVAL:  
 CONSTRUCTION DEP. APPROVAL:  
 REVISION NUMBER: A

**MAJOR OPTIONS**

OPTION A: This option is currently confirmed.  
 OPTION B: This option is currently confirmed.  
 OPTION C: This option is currently confirmed.  
 OPTION D: This option is currently confirmed.  
 OPTION E: This option is currently confirmed.

NOTE: SERVICES SHOWN HEREON HAVE BEEN LOCATED BY FIELD SURVEY ONLY.

NOTE:  
 1. LEVELS ARE TO AUSTRALIAN HEIGHT DATUM (AHD) - PM 195282 - RL 72.241 AS OF 01.09.17  
 2. AHD HEIGHT HAS BEEN DETERMINED FROM THE PM NOTED ABOVE. THIS INFORMATION HAS BEEN OBTAINED FROM THE SURVEY CONTROL DATABASE (SCDB) WEBSITE. THE ACCURACY OF THIS INFORMATION IS TO +/- 50mm. INTRAX CONSULTING ENGINEERS PTY LTD TAKES NO RESPONSIBILITY FOR THE ACCURACY OF THE INFORMATION OBTAINED FROM (SCDB). SHOULD THE CLIENT WISH TO CONFIRM THE SCDB PM MARKER THIS OFFICE SHOULD BE CONTACTED FOR A MORE DETAILED INVESTIGATION.

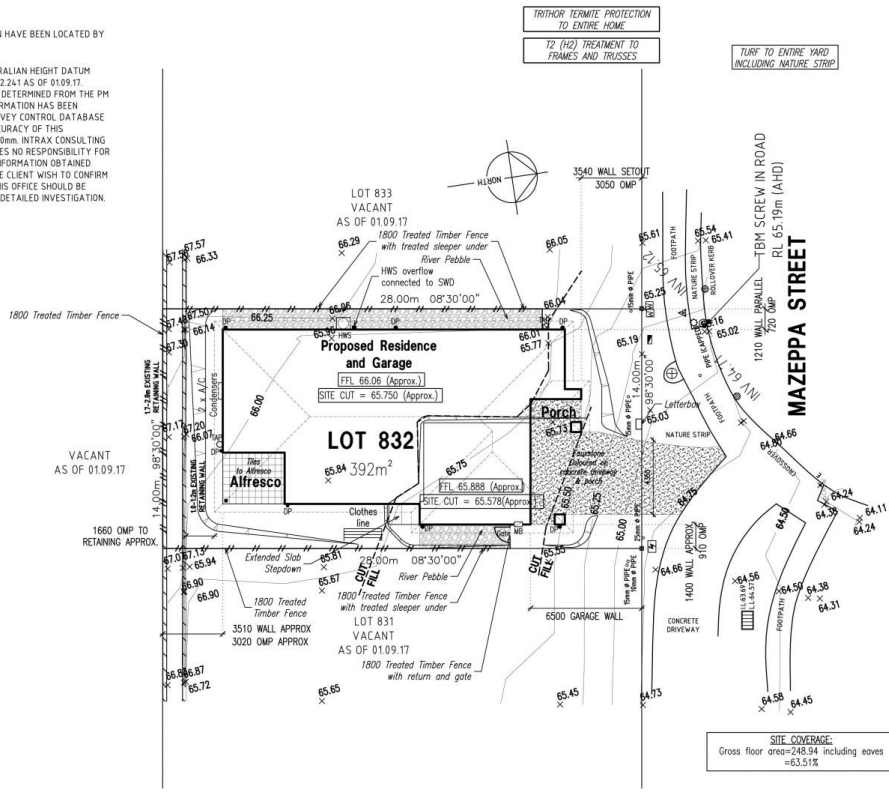

**SITE PLAN** SCALE: 1:200

Rev	Remark/Comment	Date	App
0	GROUND SURVEY	01.09.17	

**LEGEND**

- ⊙ BOLLARD
- ⊕ TELSTRA/COMMS/CABLE PIT
- ⊖ DISCHARGE POINT
- ⊗ ELECTRICITY PIT
- ⊛ ELECTRICITY BOX
- ⊙ ELECTRICITY POLE
- ⊙ LIGHT POLE
- ⊕ HYDRANT
- ⊗ MARK ON FOOTPATH
- ⊕ PEG
- ⊕ PIPE Ø 100Ø - 150Ø - 25Ø - 15Ø
- ⊕ SEWER MANHOLE
- ⊕ SEWER INSPECTION PIT
- ⊕ STAKE
- ⊕ STORMWATER GRATE
- ⊕ STORMWATER PIT
- ⊕ STREET SIGN
- ⊕ STUMP
- ⊕ PERMANENT SURVEY MARKER
- ⊕ STOP VALVE
- ⊕ TAP
- ⊕ VENT
- ⊕ WATER METER
- ⊕ SEWER MARKER STAKE
- ⊕ FLAG POLE
- ⊕ PEG
- ⊕ GATE
- ⊕ STORMWATER MANHOLE
- ⊕ SIDE ENTRY PIT
- ⊕ SILT BARRIER
- SEWER LINE
- SW - STORMWATER LINE

CHECK BEARINGS & DISTANCES WITH A CLEAR COPY OF TITLE

LEVELS ARE TO AHD  
 250mm CONTOUR INTERVAL  
 THIS IS NOT A RE-ESTABLISHMENT SURVEY

**DETAIL SURVEY**

Client: BURBANK AUSTRALIA

Address: LOT 832 MAZEPPA STREET SOUTH RIPLEY

Lot 832 SP 279903

Drawn: J.B. | Checked: Z.Z.

Date: 01.09.17 | Scale: 1:200 @ A3

Job Number: 100266

Revision: 1

**Intrax** Engineering Solutions

**Burbank**

36 Aberdeen Rd, Albion 3018 Phone: 03 9328 0333 Fax: 03 9328 0222  
 Email: info@burbank.com.au Web: www.burbank.com.au

THE DRAWING AND THE INFORMATION HEREON IS THE PROPERTY OF AND MAY NOT BE USED BY ANY MEANS WITHOUT THE PRIOR CONSENT OF BURBANK AUSTRALIA PTY. LTD.

THE CONTRACTOR IS RESPONSIBLE FOR SETTING OUT AND CHECKING ALL LEVELS AND DIMENSIONS ON SITE BEFORE COMMENCING ANY WORK.

FIGURED DIMENSIONS ARE TO BE TAKEN IN PREFERENCE TO SCALE.

BURBANK AUSTRALIA (QLD) PTY. LTD. QBSA 1046544 © COPYRIGHT

PROPOSED Wilshire 194 Summit (Eclipse)  
 LOCATION Lot 832 Mazeppa St  
 South Ripley

FOR M. Montes de Oca

DRG NAME SITE PLAN & SPECIFICATIONS

DRAWN: RDS  
 SCALE: 1:200  
 DATE: 10/09/17  
 SALES PERSON: D.G.  
 NIL FLOOR AREA: 173.54 sq.m

NO	DATE	DETAILS
A	10/09/17	NHP Issue
B	18/10/17	Contract Issue
C	18/12/17	Construction Issue

AMENDMENTS

103804

**A1**

SHEET 7 OF 7 REV C